

Injection unit TSi Plug & Spray...

In Detail

System Overview & Technical Data



Injection unit TSi. Plug & Spray...

The TSi from ABICOR BINZEL – the stand-alone welding torch injection unit for simple integration in existing or new processes. The spray pulse is triggered by the integrated activating mechanism as soon as the welding torch is moved into the TSi vertically up to the spraying position. This makes a complicated electric actuator or integration in the robot controller unnecessary.

In addition, the TSi scores with an economical and environmentally-conscious spraying process. The sealed spraying chamber prevents the anti-spatter fluid from escaping during the spray pulse and the infinitely variable spray fluid setting ensures correct dosing. Both enable the lowest

possible consumption of anti-spatter fluid and increase a safe and clean welding work environment.

Along with these properties, the TSi guarantees the familiar and even coating of the cleaned welding torch inside and out – with ABICOR BINZEL's tried and tested anti-spatter fluid and in this way prevents weld spatter from sticking.

The TSi stands for simple integration in the welding process, reliable welding torch maintenance and the efficient and environmentally-conscious use of anti-spatter fluid.

Detailed view of the roller push-button for controlling the valve

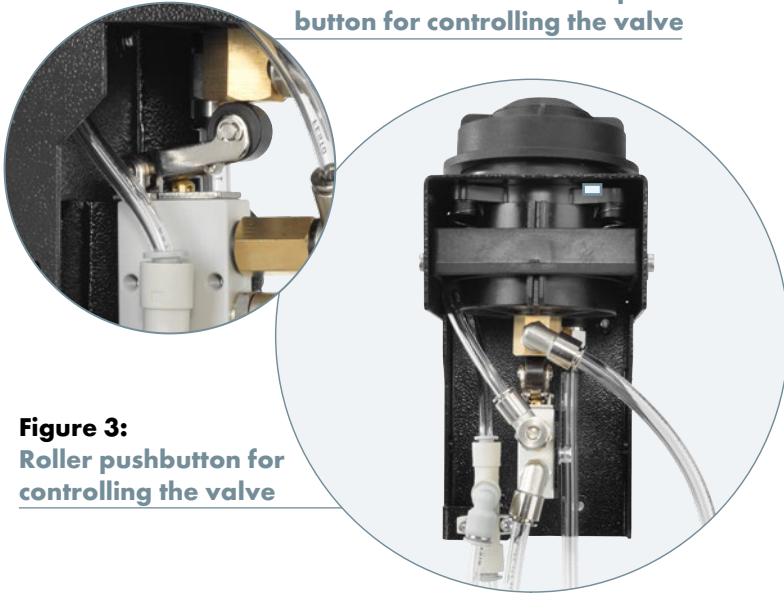

Figure 3:
Roller pushbutton for controlling the valve

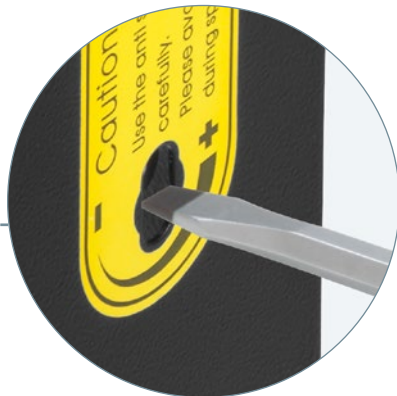

Figure 4:
Dosing the anti-spatter fluid

Arguments that speak for themselves:

- Simplest starting - electric actuator not required
- Spray pulse activated by the robot movement
- No complicated integration into the robot controller
- Sealed and highly efficient spraying process - no overspray
- Clean and safe welding environment
- Low consumption of the anti-spatter fluid
- Plug & spray - means just what it says

Figure 1:
Tool-free replacement of spare parts by means of bayonet fitting

- 1.1 Device cover
- 1.2 Seal insert
- 1.3 Pressure flange
- 1.4 Injection nozzle
- 1.5 Collecting tank

Figure 2:
Sealed spraying chamber

- No overspray and therefore no coating of the workpiece and the surroundings with anti-spatter fluid
- Individual sealing inserts for different gas nozzle diameters
- Even coating of the welding torch - inside and out
- Highly efficient spraying process
- Clean and safe welding environment

Figure 3:
Roller pushbutton for controlling the valve

- Integrated activation mechanism
- Robot movement actuates the roller pushbutton and starts the spray pulse
- Robust and maintenance-free construction

Figure 4:
Dosing the anti-spatter fluid

- Stepless dosing of the anti-spatter fluid
- Easy to adjust using a flat-tip screwdriver
- Highly efficient spraying process guaranteed
- Economic and environmentally-conscious torch maintenance

Watch on YouTube now!





Dimensions:
Injection unit TSi

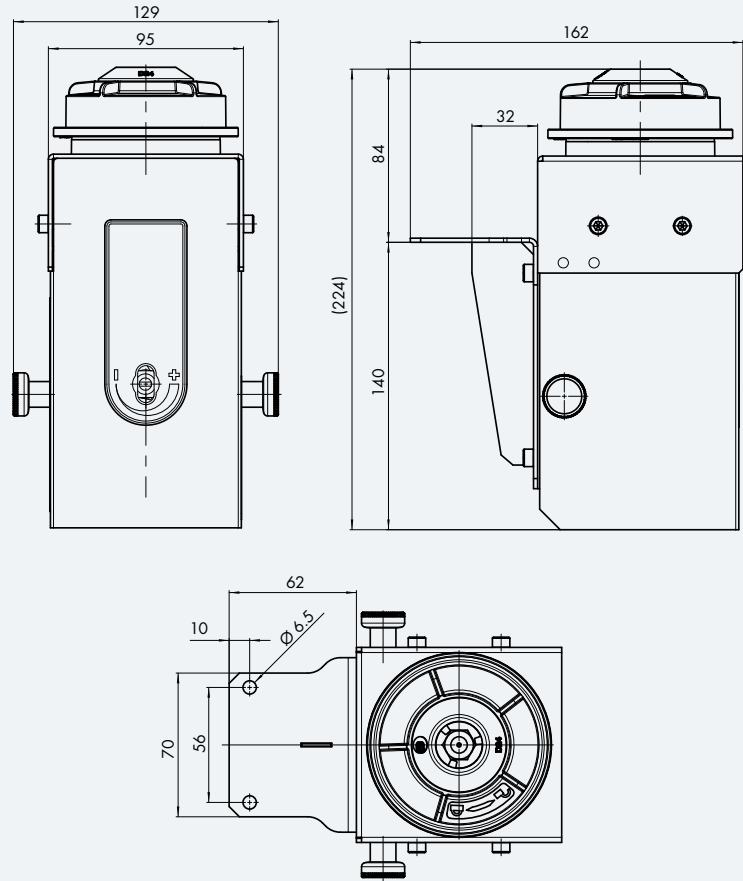

Technical Data:
Injection unit TSi

General information:

Weight: 1.5 kg (without anti-spatter fluid)

Ambient temperature in operation: 0 °C to +40 °C

Relative humidity in operation: up to 90% at 20 °C

Pneumatic connection:

Connection port: Ø 8 mm

Operating pressure: min. 0.5 MPa up to max. 0.6 MPa

Dimensions:
TSi bottle holder

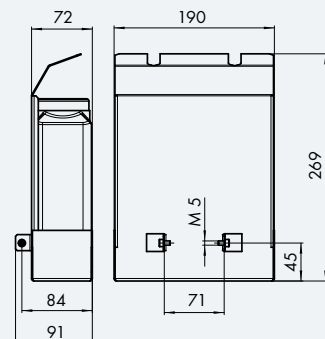

Injection unit TSi

Order Information



Injection unit TSi

No.	Type	Description	Part-No.
1	Injection unit TSi	Injection unit TSi incl. 1 litre anti-spatter fluid and three sealing inserts (Ø 20, 24, 30 mm)	830.2285.1

Spare parts for the injection unit TSi

No.	Type	Description	Part-No.
2	Device cover	Device cover with bayonet fitting	830.2237.1
3	Sealing insert: Ø 20 mm Ø 24 mm Ø 30 mm	Seal to the gas nozzle	830.2232.1 830.2233.1 830.2234.1
4	Pressure flange	Contact surface of the gas nozzle for spray pulse activation	830.2265.1
5	Injection nozzle	Injection nozzle for the even vaporisation of the anti-spatter fluid	830.2133.1
6	Collecting tank	Collecting tank and filter for excess anti-spatter fluid	830.2240.1
7	Anti-spatter fluid	1 litre bottle 5 litre canister	192.0056 192.0052
not ill.	Fixing bracket TSi/BRS	Fixing bracket for attaching the TSi to torch cleaning stations CC/LC/FP	831.0824.1



Alexander Binzel Schweisstechnik GmbH & Co. KG
Kiesacker · 35418 Buseck · GERMANY
Phone: +49 (0) 64 08 / 59-0
Fax: +49 (0) 64 08 / 59-191
E-mail: info@binzel-abicor.com

www.binzel-abicor.com