

ABIMIG® A & AT Lightweight MIG Air-cooled MIG Guns



ABIMIG® AT LW MIG Guns

Air cooled • Up to 400 A

Welding professionals do some of the most physically demanding jobs in metalworking and fabrication today.

Welders have to constantly adapt their posture to effectively access their work, while simultaneously focusing on maintaining a solid welding arc at all times.

This heavy physical strain can lead to body and joint pain, and potentially create chronic, lifetime discomfort.

For this reason, every welder wants a robust welding torch that can perform the job needed, but also is both light and powerful, and is equipped with a torchneck that has been optimized for the job.

The new air-cooled welding torch series from ABICOR BINZEL - the ABIMIG AT LW - makes the weld life easier.

The "T" interface system allows for rotating torch necks with angles and alignments that are matched to the actual welding job. The necks can be quickly switched out for easy

maintenance and improved accessibility.

With our lightweight Bikox cable and ergonomic molded handle with ball socket base and extended trigger, getting comfortable on the job is now easier than ever.

ABIMIG AT is air-cooled perfection. Welding as it should be.

Find out for yourself.

ABIMIG® AT 255 LW

Technical data (EN 60 974-7):

Rating:

Duty cycle: 60%

CO₂ 230 A

Mixed gases 220 A

M21 (DIN EN 439)

Wire size: 0.8 - 1.2 mm (.030" - .045")

ABIMIG® AT 355 LW

Technical data (EN 60 974-7):

Rating:

Duty cycle: 60%

CO₂ 340 A

Mixed gases 310 A

Wire size: 0.9 - 1.6 mm (.035" - .062")

ABIMIG® AT 415 LW

Technical data (EN 60 974-7):

Rating:

Duty cycle: 60%

CO₂ 400 A

Mixed gases 355 A

M21 (DIN EN 439)

Wire size: 0.9 - 2.4 mm (.035" - .094")

Ordering Chart

| A | T | 3 | 15 | C | T | - | 35 | L1 | T |
|-----------------------------------|------------------------------------|--|---|--|-------------------------------|---|--|-------------------------------------|----------|
| Torch Model | Handle | Amperage | Cable Length | Cable Type | Nozzle | Wire Size | Back End | Type | |
| Torch Model A - ABIMIG® | Handle T - Rotating Neck | Amperage 2 - 200 Amp (255 Model) 3 - 300 Amp (355 Model) 4 - 400 Amp (415 Model) | Cable Length 10 Feet 15 Feet 20 Feet 25 Feet | Cable Type No Letter = Lightweight C = Copper | Nozzle T - Threaded | Wire Size 35 - .035 Inches ¹ 45 - .045 Inches 52 - .052 Inches ² 62 - .062 Inches ² 78 - .078 Inches ³ 94 - .094 Inches ³ | Back End E - Euro L - Lincoln External gas L1 - Lincoln 10, PF74/84 L2 - Lincoln Power MIG HT - Hobart/Tweco M - Miller Standard M1 - Miller Multimatic ² X - No connector kit installed | Type T - Extended Trigger | |

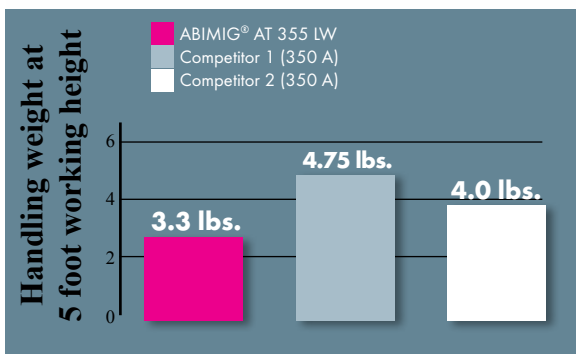
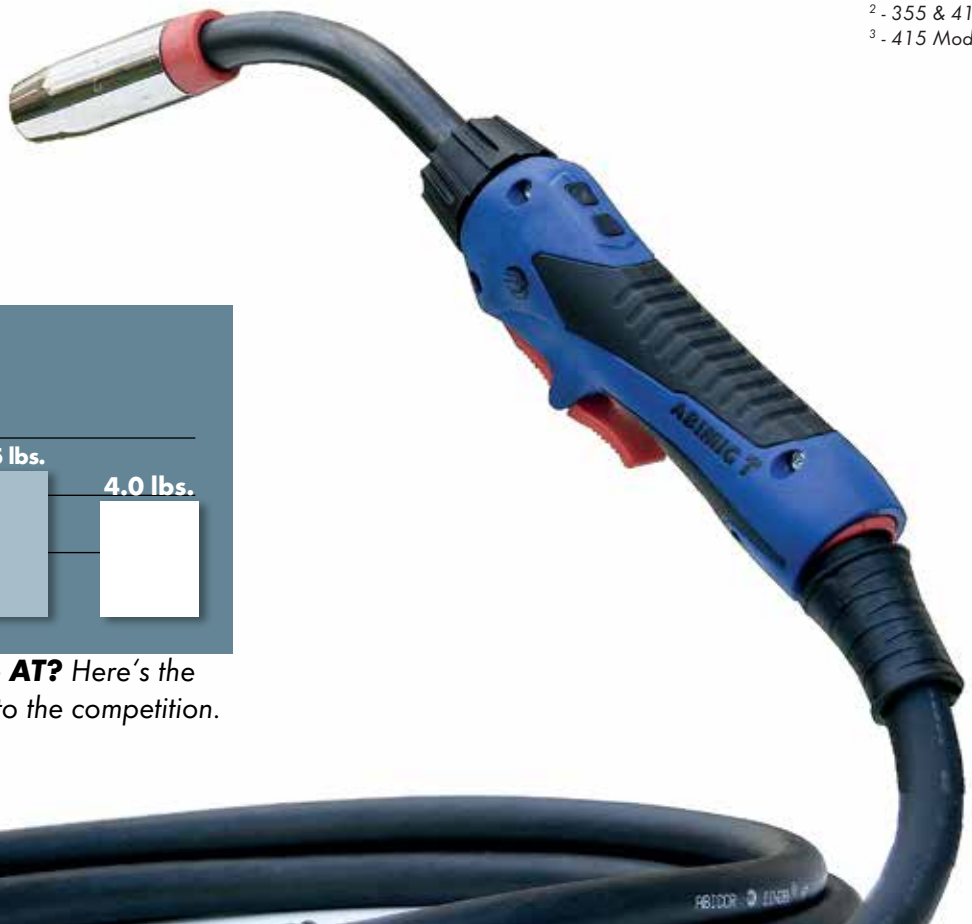

How Lightweight is the AT? Here's the weight average compared to the competition.

¹ - 255 & 355 Models
² - 355 & 415 Models
³ - 415 Model Only

ABIMIG® AT LW MIG Guns

Body Cable Assembly - ABIMIG AT

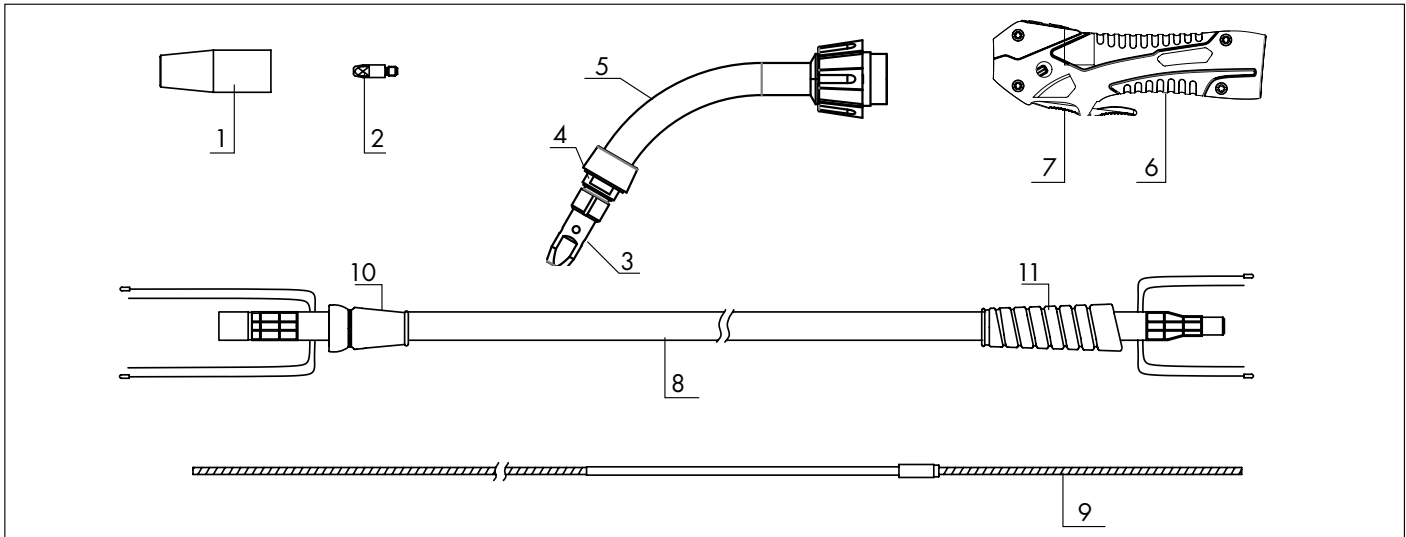

ABIMIG AT 255
Part No.

ABIMIG AT 355
Part No.

ABIMIG AT 415
Part No.

| Item No. | Description | Part No. | Part No. | Part No. |
|----------|---|--|----------|-----------|
| 1 | Nozzle | | | |
| 2 | Contact Tip | | | |
| 3 | Tip holder/Diffuser | See Page 9 & 10 for complete list of ABIMIG AT and ABIMIG A consumables. | | |
| 4 | Adapter Piece | | | |
| 5 | Standard Swanneck (x -135, y -115, 60D) | 004.0709 | - | - |
| | Standard Swanneck (x -165, y -110, 60D) | - | 014.0570 | - |
| | Standard Swanneck (x -160, y -130, 60D) | - | - | 016.0039 |
| 6 | Handle Complete | 180.D077 | 180.D077 | 180.D077 |
| 7 | Trigger only | 185.D118 | 185.D118 | 185.D118 |
| 8 | Bikox 10 feet (415 cable shown) | 160.H238 | 160.H046 | 160.H344 |
| | Bikox 15 feet | 160.H242 | 160.H248 | 160.H377 |
| | Bikox 20 feet | 160.H433 | 160.H397 | 160.H442 |
| | Bikox 25 feet | 160.H263 | 160.H265 | 160.1395 |
| 9 | Liner | See Page 9 & 10 for complete list of ABIMIG AT and ABIMIG A consumables. | | |
| 10 | Cable Support Front | 400.D574 | 400.D574 | 400.D574* |
| 11 | Cable Support Rear | 400.1010 | 400.1010 | 400.D518* |
| N/S | Contact Tip Wrench | 191.0001 | 191.0001 | 191.0001 |

*Cable Support Front and Rear are included in ABIMIG AT 415 as part of #8 Bikox cable.

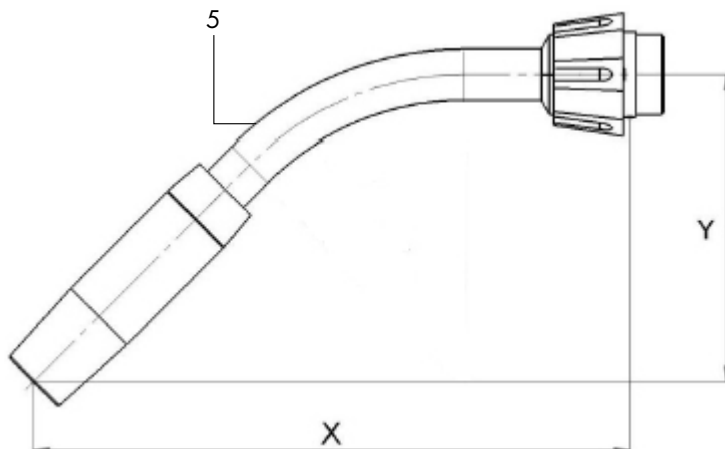

Change out torch necks in seconds and get back to doing what you love - welding.

AT's Average Neck Change Time: **<1 min.**

Standard MIG Neck Change Time: **30 min.**

Swannecks - Short, Long, 180 Flex, & Extra Long

014.H538

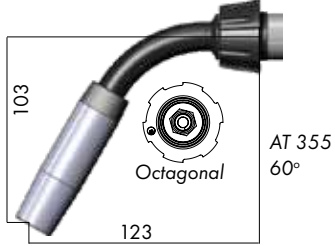

016.D435

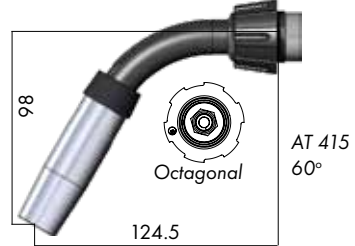

014.H534



016.D410



014.0630



014.H515



014.H494



014.H500

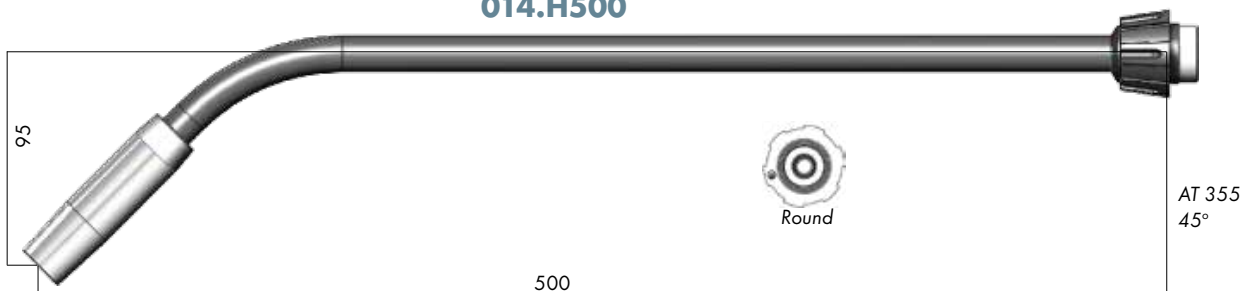

ABIMIG® A LW MIG Guns

Air cooled • Up to 400 A



ABIMIG A 255 LW

Technical data (EN 60 974-7):

Rating:

Duty cycle: 60%

CO₂ 230 A

Mixed gases 220 A

M21 (DIN EN 439)

Wire size: 0.8 - 1.2 mm (.030" - .045")

ABIMIG A 355 LW

Technical data (EN 60 974-7):

Rating:

Duty cycle: 60%

CO₂ 340 A

Mixed gases 310 A

M21 (DIN EN 439)

Wire size: 0.9 - 1.6 mm (.035" - .062")

ABIMIG A 415 LW

Technical data (EN 60 974-7):

Rating:

Duty cycle: 60%

CO₂ 400 A

Mixed gases 355 A

M21 (DIN EN 439)

Wire size: 0.9 - 2.4 mm (.035" - .094")

For a fixed neck and lightweight air-cooled welding option, the **ABIMIG A** offers the same lightweight and ergonomic handle design of the rotating AT. For comfort, our handle is contoured for the welder's hand, and the ball socket base creates a greater range of motion in the wrist than most welding torches on the market.

Combining this comfort with the lightweight Bikox cable assembly assures an easy to operate gun.

And, with the high quality BINZEL consumables, you will churn through less parts while saving on time and cost.

Welding as it should be. Designed with the welder in mind.

Ordering Chart

| A | F | 3 | 15 | T - | 35 | L1 | S |
|-----------------------------------|---------------------------------|--|---|-------------------------------|---|--|------------------------------------|
| Torch Model | Handle | Amperage | Cable Length | Nozzle | Wire Size | Back End | Handle |
| Torch Model A - ABIMIG® | Handle F - Fixed Neck | Amperage 2 - 200 Amp (255 Model) 3 - 300 Amp (355 Model) 4 - 400 Amp (415 Model) | Cable Length 10 Feet 15 Feet 20 Feet 25 Feet | Nozzle T - Threaded | Wire Size 35 - .035 Inches ¹ 45 - .045 Inches 52 - .052 Inches ² 62 - .062 Inches ² 78 - .078 Inches ³ 94 - .094 Inches ³ | Back End E - Euro L - Lincoln External gas L1 - Lincoln 10, PF74/84 L2 - Lincoln Power MIG HT - Hobart/Tweco M - Miller Standard M1 - Miller Multimatic ² X - No connector kit installed | Handle S - Short Trigger |

Weld Cable Cover



Features & Benefits

- 1000 Denier Cordura with flame retardant coating
- Extremely lightweight
- Continuous temp rating: +250°F
- Momentary temp rating: 800°F
- Excellent UV protection
- Unaffected by water, oils, and mild solvents
- Excellent resistance to abrasion, weld spatter, puncture and tear resistance

ABIMIG® A LW MIG Guns

Body Cable Assembly

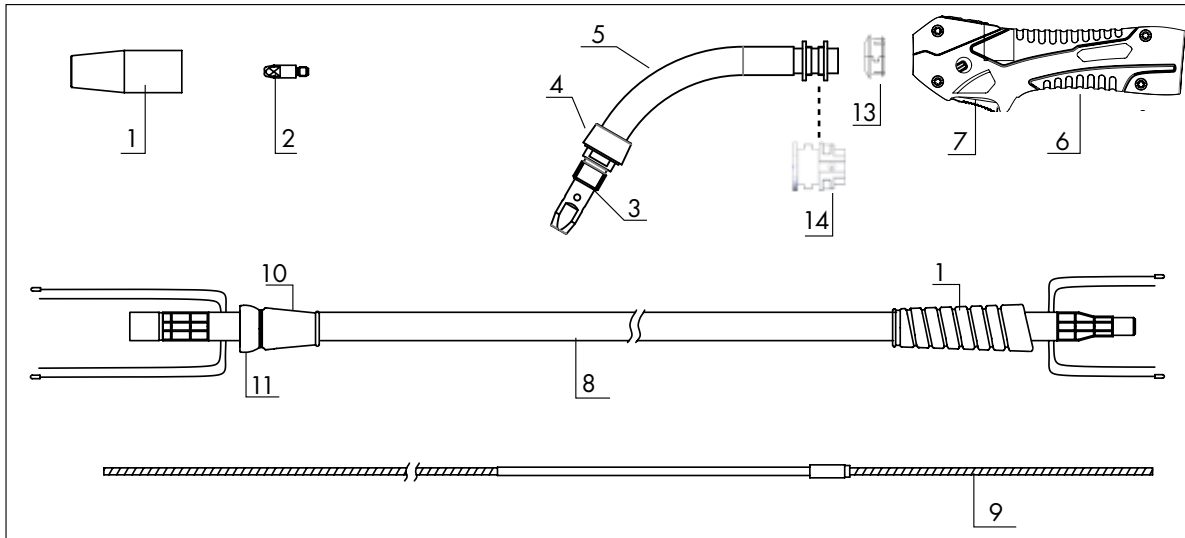

| Item No. | Description | ABIMIG A 255 | ABIMIG A 355 | ABIMIG A 415 |
|----------|----------------------------------|--|--------------|--------------|
| | | Part No. | Part No. | Part No. |
| 1 | Nozzle | | | |
| 2 | Contact Tip | | | |
| 3 | Tip holder/Diffuser | See Page 9 & 10 for complete list of ABIMIG AT and ABIMIG A consumables. | | |
| 4 | Adapter Piece | | | |
| 5 | Swanneck Assembly 60 Degree | 767.0108 | 767.0109 | 767.0140 |
| 6 | Handle Complete | 180.0181 | 180.0181 | 180.0181 |
| 7 | Trigger only | 185.0135 | 185.0135 | 185.0135 |
| 8 | Bikox 10 feet (415 cable shown) | 160.H032 | 160.H046 | 160.H344 |
| | Bikox 15 feet | 160.H242 | 160.H248 | 160.H377 |
| | Bikox 20 feet | 160.H262 | 160.H264 | 160.H442 |
| | Bikox 25 feet | 160.H263 | 160.H265 | 160.1395 |
| 9 | Liner | See Page 9 & 10 for complete list of ABIMIG AT and ABIMIG A consumables. | | |
| 10 | Cable Support Front | 400.D574 | 400.D574 | 400.D574* |
| 11 | Red Ball Joint Halves (2 Needed) | 400.D561 | 400.D561 | 400.D561 |
| 12 | Cable Support Rear | 400.1010 | 400.1010 | 400.D518* |
| 13 | Protection Caps (2) | 014.H282 | 014.H282 | 014.H283 |
| 14 | Torch Body Support | 400.1756** | - | - |
| N/S | Contact Tip Wrench | 191.0001 | 191.0001 | 191.0001 |

*Cable Support Front and Rear are included in ABIMIG A 415 as part of #8 Bikox cable.

**This piece is only required for the ABIMIG A 255 model; two are needed

Consumables

Torch Model

A/AT 255 Series

A/AT 355 Series

A/AT 415 Series

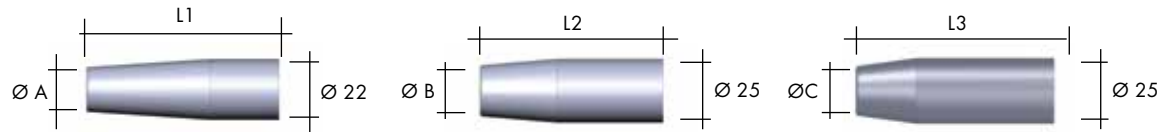

| Nozzles | Ø A | L1 | Part No. | Ø B | L2 | Part No. | Ø C | L3 | Part No. |
|----------------|---------|-------|-----------|---------|-------|-----------|--------|-------|-----------|
| Conical recess | Ø 1/2" | 70 mm | 145.D015* | Ø 1/2" | 72 mm | 145.D025 | Ø 1/2" | 85 mm | 145.D243 |
| Conical recess | Ø 9/16" | 70 mm | 145.D016 | Ø 5/8" | 72 mm | 145.D026* | Ø 5/8" | 85 mm | 145.D244* |
| Conical recess | Ø 5/8" | 70 mm | 145.D011 | Ø 3/4" | 72 mm | 145.D021 | Ø 3/4" | 85 mm | 145.D245 |
| Conical flush | Ø 1/2" | 67mm | 145.D013 | Ø 9/16" | 69 mm | 145.D023 | - | - | - |
| Conical flush | Ø 9/16" | 67mm | 145.D012 | Ø 5/8" | 69 mm | 145.D022 | - | - | - |

* Denotes Factory Standard

A/AT 255 Series



M6

A/AT 355 & 415 Series



M8

A/AT 415 Series

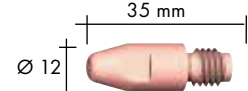

M10

Contact Tips

| | | M6 | M8 | M10 |
|---|---------|------------|------------|------------|
| E-Cu Standard Copper | Ø .030" | 140.0051 | 140.0114 | - |
| | Ø .035" | 140.0169 | 140.0214 | - |
| | Ø .040" | 140.0242 | 140.0313 | - |
| | Ø .045" | 140.0379 | 140.0442 | - |
| | Ø .052" | - | 140.0533 | - |
| | Ø .062" | - | 140.0587 | - |
| | Ø .078" | - | 140.0653 | - |
| E-Cu for Al Standard Copper for Aluminum | Ø .030" | 141.0001 | 141.0003 | - |
| | Ø .035" | 141.0004 | 141.0043 | - |
| | Ø .040" | 141.0006 | 141.0008 | - |
| | Ø .045" | 141.0010 | 141.0075 | - |
| | Ø .052" | - | 141.0055 | - |
| | Ø .062" | - | 141.0022 | - |
| | Ø .078" | - | - | - |
| CuCrZr Heavy Duty Copper | Ø .030" | 140.0054 | 140.0117 | - |
| | Ø .035" | 140.0172 | 140.0217 | * 140.1248 |
| | Ø .040" | 140.0245 | 140.0316 | * 140.0348 |
| | Ø .045" | 140.0382 | 140.0445 | * 140.0481 |
| | Ø .052" | - | 140.0536 | * 140.0547 |
| | Ø .062" | - | 140.0590 | * 140.0616 |
| | Ø .078" | - | * 140.0656 | * 140.0665 |
| Ø .094" | - | * 140.0679 | * 140.0698 | |
| Silver-plated Heavy Duty Copper Silver-plated | Ø .030" | 147.0054 | 147.0117 | - |
| | Ø .035" | 147.0172 | 147.0217 | - |
| | Ø .040" | - | 147.0316 | - |
| | Ø .045" | 147.0382 | 147.0445 | * 147.0481 |
| | Ø .052" | 147.0519 | 147.0536 | * 147.0547 |
| | Ø .062" | - | 147.0590 | * 147.0616 |
| | Ø .078" | - | 147.0656 | - |
| Ø .094" | - | - | * 147.0698 | |

* Note: M6 tip is standard on ABIMIG® AT and A 255. M8 tips are standard on ABIMIG® AT and A 355 and 415 Series. M10 tips requires tip holder H4T-10-C and are optional for ABIMIG® AT and A 415. Only 415 Series models can accept .078" and .094" size contact tips. Additional configurations are available. Contact customer service for details at 1-800-542-4867

ABIMIG® AT & A LW MIG Guns

Consumables

Tapered Consumables for ABIMIG 355 Air-cooled Torches

Call product department for more details.

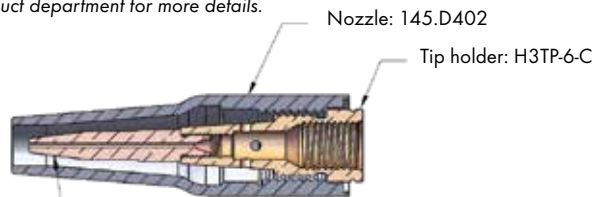

- Contact tip .030" M6 CU 173 P/N 140.1532
- Contact tip .035" M6 CU 173 P/N 140.1533
- Contact tip .045" M6 CU 173 P/N 140.1534
- Contact tip .035" M6 CZ Silver Plated 173 P/N 147.1609
- Contact tip .045" M6 CZ Silver Plated 173 P/N 147.1610

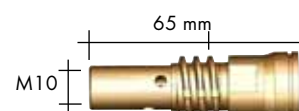
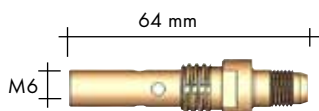

Contact tip holder (10 pcs.)

| | | | |
|----------------------|---------|---------|----------|
| A/AT 255, 355, & 415 | H2T-6-C | H3T-8-C | H4T-8-C* |
| A/AT 355 | H3T-6-C | - | - |

* Optional HD M10 available P/N H4T-10-C

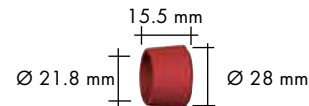
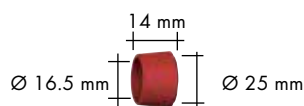
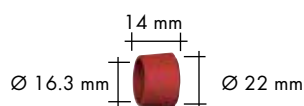

Adapter piece (1 pcs.)

| | | | |
|-----------------------|----------|----------|----------|
| ABIMIG A 255/355/415 | 767.D656 | 767.0107 | 016.D393 |
| ABIMIG AT 255/355/415 | 767.D656 | 767.D668 | 016.D393 |

Neck Liners

ABIMIG AT Only

| ABIMIG AT Model | Swanneck Item No. (see pgs. 4 & 5) | .035 - .045" Steel | .052 - .062" Steel | .024 - .035" Aluminum | .040 - .052" Aluminum |
|-----------------|------------------------------------|--------------------|--------------------|-----------------------|-----------------------|
| AT 255 | 004.0709 | S3545 | - | B2440 | B4052 |
| AT 355 | 014.0570 | S3545 | 122.D045 | B2440 | B4052 |
| | 014.H538 | S3545 | 122.D045 | B2440 | B4052 |
| | 014.H534 | S3545 | 122.D045 | B2440 | B4052 |
| | 014.H515 | S3545 | 122.D045 | B2440 | B4052 |
| | 014.H494 | 122.D088 | 122.D067 | - | - |
| | 014.H500 | S3545XL | S5262XL | - | - |
| AT 415 | 014.D435 | 122.D077 | 122.D078 | B2440 | B4052 |
| | 014.D094 | 122.D077 | 122.D078 | B2440 | B4052 |
| | 014.D410 | 122.D077 | 122.D078 | B2440 | B4052 |
| | 016.0038 | 122.D077 | 122.D078 | B2440 | B4052 |

Torch Liners



| Liner Type | Wire Size | A/AT 255 & 355 Series | | A/AT 415 Series | |
|-------------------|---------------|-----------------------|----------------|-----------------|---------------|
| | | for 15 ft | for 25 ft | for 15 ft | for 25 ft |
| Liner | Ø .035"-.045" | SI-3545-17PT | SI-3545-28PT | SI4-3545-17PT | SI4-3545-28PT |
| | Ø .052"-.062" | SI-5262-17PT** | SI-5262-28PT** | SI4-5262-17PT | SI4-5262-28PT |
| | Ø .078"-.094" | - | - | SI4-7894-17PT | SI4-7894-28PT |
| Combi PA liner | Ø .035"-.045" | 128.9047 | - | 128.9047* | - |
| | Ø .052"-.062" | 128.9050 | - | 128.9050* | - |
| Carbon PTFE liner | Ø .035"-.045" | 127.9003 | - | 127.9003* | - |
| | Ø .052"-.062" | 127.9006 | - | 127.9006* | - |

* 415 series torches require collet spacer P/N 130.9006. Item sold separately.

** .052-.062" is not recommended for 255 series torches.

ABIMIG® AT & A LW MIG Guns

Connectors Kits

Direct Plug Connector: Miller

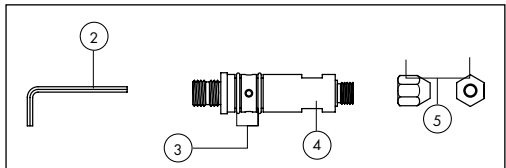

| | | 255 | 355 | 415 |
|----------|-----------------------|----------|----------|----------|
| Item No. | Description | Part No. | Part No. | Part No. |
| 2 | Allen Wrench 2.5mm | 191.0017 | 191.0017 | 191.0017 |
| 3 | O-Rings (2 required) | 165.9006 | 165.9006 | 165.9006 |
| 4 | Connector Plug Miller | 501.9183 | 501.9183 | 501.9245 |
| 5 | Liner Nut MR | 272.9018 | 272.9018 | 272.9036 |

Direct Plug Connector: Millermatic

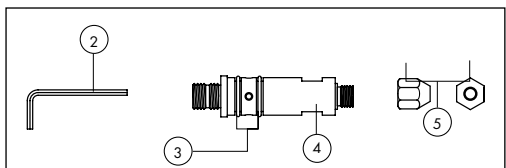

| | | 255 | 355 | 415 |
|----------|----------------------------|----------|----------|----------|
| Item No. | Description | Part No. | Part No. | Part No. |
| 2 | Allen Wrench 2.5mm | 191.0017 | 191.0017 | 191.0017 |
| 3 | O-Rings (2 required) | 165.9006 | 165.9006 | 165.9006 |
| 4 | Connector Plug Millermatic | 501.9291 | 501.9291 | - |
| 5 | Liner Nut MR | 272.9018 | 272.9018 | 272.9036 |

Direct Plug Connector: Hobart/Tweco

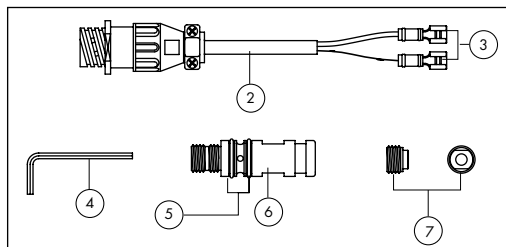

| | | 255 | 355 | 415 |
|----------|--------------------------|----------|----------|----------|
| Item No. | Description | Part No. | Part No. | Part No. |
| 2 | Trigger Lead Jumper HT | 175.9120 | 175.9120 | 175.9120 |
| 3 | Connector Wire 1/4" Male | 175.9074 | 175.9074 | 175.9074 |
| 4 | Allen Wrench 2.5mm | 191.0017 | 191.0017 | 191.0017 |
| 5 | O-Rings (2 required) | 165.0025 | 165.0025 | 165.0025 |
| 6 | Connector Plug HT | 331.9003 | 331.9003 | 501.9246 |
| 7 | Liner Nut HT/LN | 272.9017 | 272.9017 | 272.9035 |

Direct Plug Connector: Lincoln

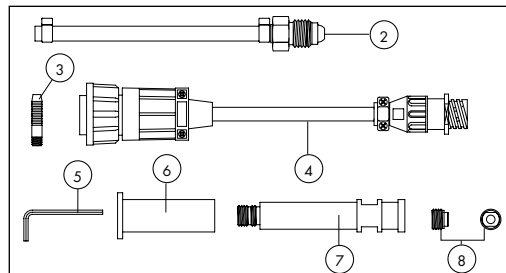

| | | 255 | 355 | 415 |
|----------|-------------------------|----------|----------|----------|
| Item No. | Description | Part No. | Part No. | Part No. |
| 2 | Gas Hose Assembly | 102.9149 | 102.9149 | 102.9149 |
| 3 | Gas Fitting with M6 THD | 353.0002 | 353.0002 | 353.0002 |
| 4 | Trigger Lead Jumper LN | 175.9121 | 175.9121 | 175.9121 |
| 5 | Allen Wrench 2.5mm | 191.0017 | 191.0017 | 191.0017 |
| 6 | Insulator Bushing | AC2030 | AC2030 | AC2030 |
| 7 | Connector Plug L | 501.9191 | 501.9191 | 501.9241 |
| 8 | Liner Nut HT/LN | 272.9017 | 272.9017 | 272.9035 |

Direct Plug Connector: Lincoln 10

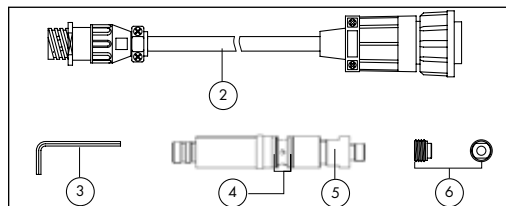

| | | 255 | 355 | 415 |
|----------|------------------------|----------|----------|----------|
| Item No. | Description | Part No. | Part No. | Part No. |
| 2 | Trigger Lead Jumper LN | 175.9121 | 175.9121 | 175.9121 |
| 3 | Allen Wrench 2.5 mm | 191.0017 | 191.0017 | 191.0017 |
| 4 | O-Rings (2 required) | 165.0025 | 165.0025 | 165.0025 |
| 5 | Connector Plug HT | 501.9247 | 501.9247 | 501.9247 |
| 6 | Liner Nut HT/LN | 272.9017 | 272.9017 | 272.9035 |

Direct Plug Connector: Lincoln PowerMIG

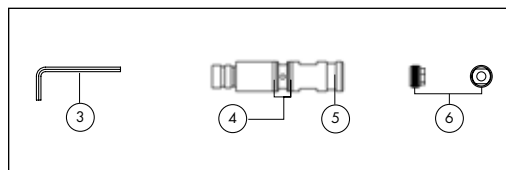

| | | 255 | 355 | 415 |
|----------|----------------------|----------|----------|----------|
| Item No. | Description | Part No. | Part No. | Part No. |
| 3 | Allen Wrench 2.5 mm | 191.0017 | 191.0017 | 191.0017 |
| 4 | O-Rings (2 required) | 165.0025 | 165.0025 | 165.0025 |
| 5 | Connector Plug HT | 501.9243 | 501.9243 | 501.2778 |
| 6 | Liner Nut HT/LN | 272.9017 | 272.9017 | 272.9035 |

Note: Connector part numbers apply to both ABIMIG AT and ABIMIG A torches.

The paper in this printed piece is 100% PCW and comes from forest that are certified and managed for sustainability. By using this paper, we save 130 trees, 12,800 gallons of water and eliminated 2870 pounds of solid waste.

Binzel S.A DE C.V.
Municipio Pabellon de Arteaga 102
Valle De Aguascalientes, 20358
San Francisco de los Romo, Ags. Mexico
Phone: +52(499) 973.0133
Fax: +52(499) 973.1388
E-Mail: info@binzel.com.mx



ABICOR BINZEL USA, Inc.
650 Medimmune Court, Suite 110
Frederick, MD 21703
Phone: 800.542.4867
Fax: 301.846.4497
E-Mail: customerservice@abicorusa.com

www.binzel-abicor.com